



GLASSLINE

Product overview



GLASSLINE –

The system supplier for frameless glass design

As a system supplier for frameless glass design, our modular products combine clever engineering with maximum transparency, tested safety and comfortable installation. For planners and contractors, this combination means considerable time and cost savings, as well as maximum planning security with simultaneous minimal planning effort.



Products by GLASSLINE are

- ✓ Glass railing family **BALARDO**
- ✓ Aluminium railing system **BALUGA**
- ✓ French balconies **BALMERO**
- ✓ Glass canopy range **CANOPY**
- ✓ The **POINTFIX** glass fixings
- ✓ The ETICS mounting system **FIX'N SLIDE**

All GLASSLINE products are made in Germany and guarantee superb quality with their high-grade materials and precise workmanship.



Glass railing systems

- 4 BALARDO *hybrid*
- 6 BALARDO *hybrid lite*
- 8 BALARDO *hybrid hd*
- 10 BALARDO *aqua control*
- 12 BALARDO *core*
- 14 BALARDO *core smart*
- 16 BALARDO *core hd*
- 18 BALARDO *steel*
- 20 BALARDO *wave*

Aluminium railing system

- 22 BALUGA *easy*

French balconies

- 24 BALMERO

Canopy systems

- 26 CANOPY *cloud*
- 28 CANOPY *classic*

Glass fixings

- 30 POINTFIX

Component anchoring in ETICS

- 32 FIX*N SLIDE

BALARDO *hybrid*

The safe system with stepless adjustability



- ✓ With General Building Inspectorate approval (AbP)
- ✓ With approved type statics
- ✓ 4 different system profiles
- ✓ Rail loads up to 2 kN/m
- ✓ With integrated adjustability of ± 15 mm with a glass height of 1,000 mm
- ✓ Deployment also in sports facilities, tested ball impact safety
- ✓ LGA-tested safety
- ✓ Glass: VSG 2 x 8 mm and 2 x 10 mm with PVB or SGP 1.52 mm
- ✓ For private and public construction projects
- ✓ Adjustable for indoors and outdoors

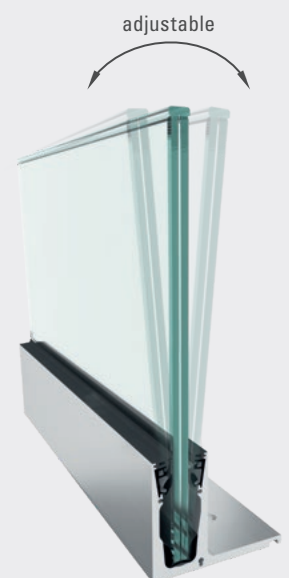

Anti-fall glazing DIN 18008

Floor mounting



Side mounting

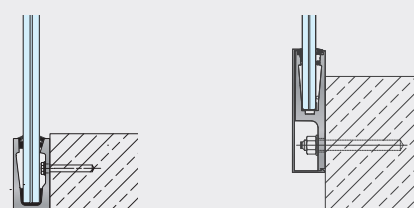

	Floor mounting		Side mounting	
Profiles				
Max. wind load with rail load of 0.5 kN/m & glass height of 1,100 mm	2.20 kN/m ²	2.20 kN/m ²	3.03 kN/m ²	2.14 kN/m ²
Max. wind load with rail load of 1.0 kN/m & glass height of 1,100 mm	2.20 kN/m ²	2.20 kN/m ²	2.40 kN/m ²	1.60 kN/m ²

The CLEVERFIX mounting set



BALARDO *hybrid lite*

The filigree system with infinitely variable multidimensional adjustability



- ✓ With General Building Inspectorate approval (AbP)
- ✓ With approved type statics
- ✓ 4 profiles and 6 systems for different floor constructions up to 220 mm
- ✓ Up to 1.0 kN/m spar load
- ✓ With integrated adjustability of max. 30 mm with a glass height of 1,000 mm
- ✓ Quick and easy assembly
- ✓ Glass: VSG-ESG 2 x 6 and 2 x 8 mm with PVB 1.52 mm
- ✓ For private and public construction projects

Anti-fall glazing DIN 18008

Floor mounting



Side mounting

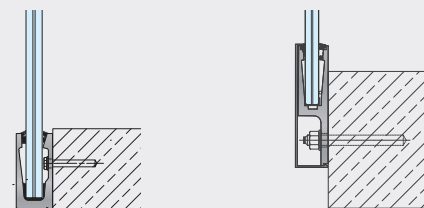

	Top 1	Top 4	Side 1	Side 3
Profiles				
Max. wind load with rail load of 0.5 kN/m & glass height of 1,100 mm	1.40 kN/m ²	1.40 kN/m ²	1.40 kN/m ²	1.40 kN/m ²
Max. wind load with rail load of 1.0 kN/m & glass height of 1,100 mm	0.90 kN/m ²	0.90 kN/m ²	0.90 kN/m ²	0.90 kN/m ²

Floor structure

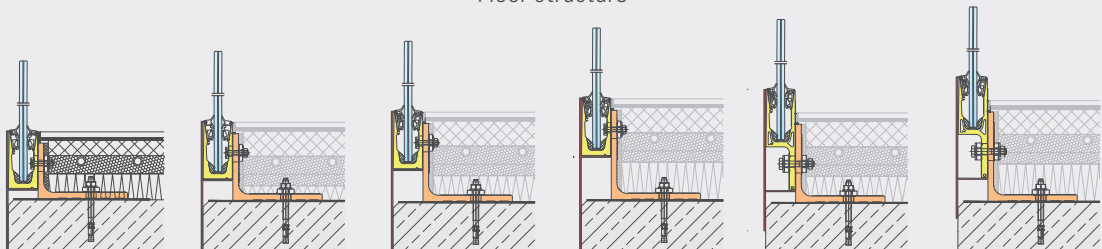

	System 1	System 2	System 3	System 4	System 5	System 6
Max. wind load with rail load of 0.5 kN/m & glass height of 1,100 mm	1.20 kN/m ²	1.20 kN/m ²	1.20 kN/m ²	1.20 kN/m ²	1.20 kN/m ²	1.20 kN/m ²
Max. wind load with rail load of 1.0 kN/m & glass height of 1,100 mm	0.90 kN/m ²	0.90 kN/m ²	0.90 kN/m ²	0.90 kN/m ²	0.90 kN/m ²	0.90 kN/m ²

BALARDO *hybrid hd*

The safe system with stepless adjustability



- ✓ With General Building Inspectorate approval (AbP)
- ✓ With approved type statics
- ✓ 4 different system profiles
- ✓ Up to 3.0 kN/m spar load
- ✓ With integrated adjustability up to max. 30 mm for a glass height of 1,000 mm
- ✓ Deployment also in sports facilities, tested ball impact safety
- ✓ LGA-tested safety
- ✓ Pane widths up to 6,000 mm, pane heights up to 2,100 mm
- ✓ Glass: VSG 2 x 10 mm and 2 x 12 mm with PVB or SGP 1.52 mm
- ✓ For public construction projects
- ✓ For indoors and outdoors
- ✓ For areas with elevated wind loads



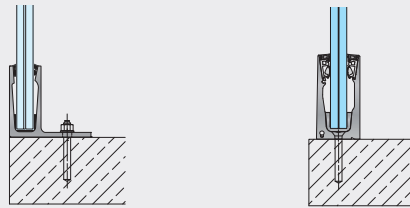

Anti-fall glazing DIN 18008

Floor mounting

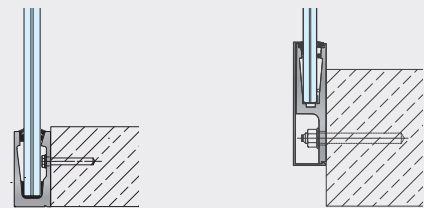

Side mounting



	Top 1	Top 4	Side 1	Side 3
Profiles				
Max. wind load with rail load of 0.5 kN/m & glass height of 1,100 mm	4.08 kN/m ²	4.12 kN/m ²	4.12 kN/m ²	4.12 kN/m ²
Max. wind load with rail load of 1.0 kN/m & glass height of 1,100 mm	3.21 kN/m ²	3.21 kN/m ²	2.84 kN/m ²	2.76 kN/m ²

The CLEVERFIX mounting set



BALARDO *aqua control*

BALARDO *hybrid* glass railing with integrated controlled balcony drainage system

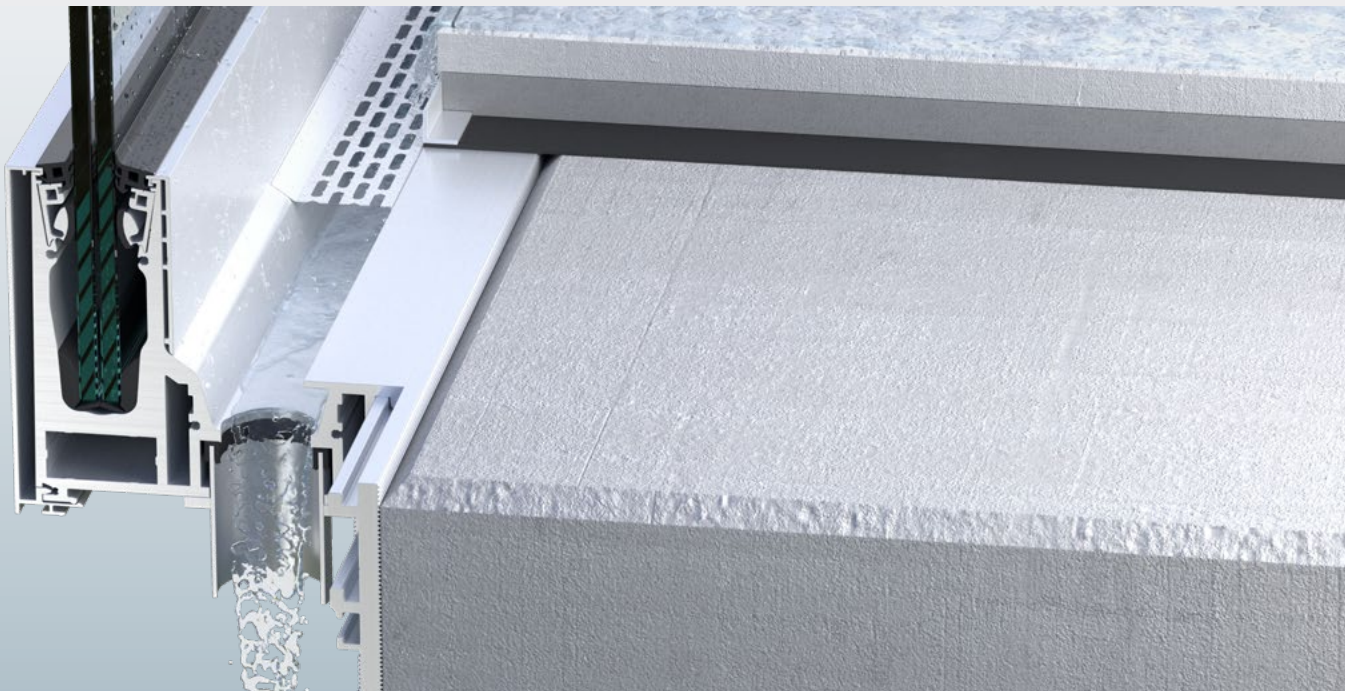

- ✓ ift-tested sealing tightness
- ✓ 9 systems with tolerance compensation for different floor structures
- ✓ Up to 1.0 kN/m spar load
- ✓ With integrated adjustability up to max. 30 mm for a glass height of 1,000 mm
- ✓ Water supply accessible from above at any time
- ✓ Accessible drain lines even with ETICS
- ✓ Variable fastening to the substructure
- ✓ Multidimensional adjustability
- ✓ Adjustability of the glass pane

Floor structure

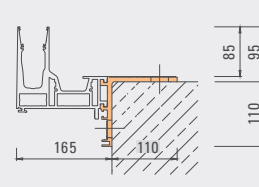
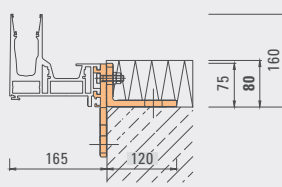
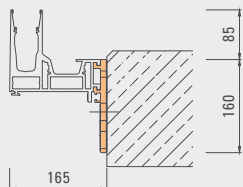

	System 1	System 2	System 3A
Max. wind load with rail load of 0.5 kN/m & glass height of 1,100 mm	2.20 kN/m ²	2.20 kN/m ²	2.20 kN/m ²
Max. wind load with rail load of 1.0 kN/m & glass height of 1,100 mm	1.60 kN/m ²	1.70 kN/m ²	1.40 kN/m ²

Floor structure

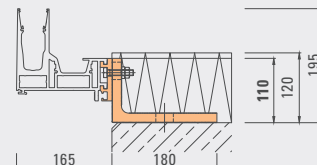
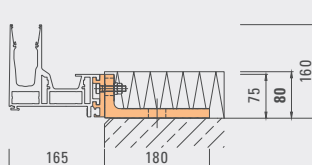
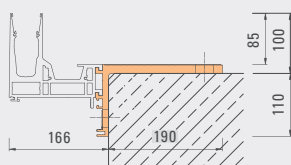

	System 3B	System 4	System 5
Max. wind load with rail load of 0.5 kN/m & glass height of 1,100 mm	2.20 kN/m ²	2.00 kN/m ²	2.00 kN/m ²
Max. wind load with rail load of 1.0 kN/m & glass height of 1,100 mm	1.90 kN/m ²	1.40 kN/m ²	1.30 kN/m ²

Floor structure

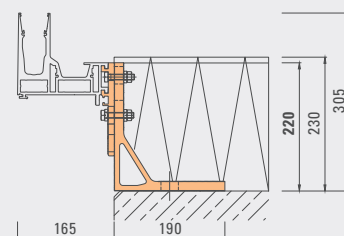
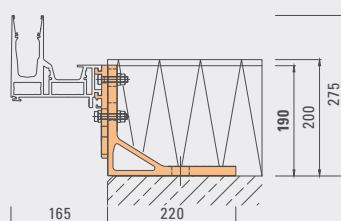
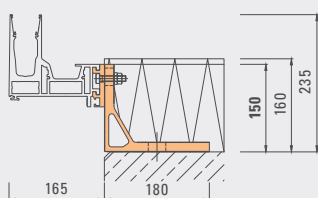

	System 6	System 7	System 8
Max. wind load with rail load of 0.5 kN/m & glass height of 1,100 mm	1.90 kN/m ²	2.20 kN/m ²	2.00 kN/m ²
Max. wind load with rail load of 1.0 kN/m & glass height of 1,100 mm	1.20 kN/m ²	2.20 kN/m ²	1.40 kN/m ²

BALARDO *core*

The number 1 for permanent installation



- ✓ With General Building Inspectorate approval (AbP)
- ✓ With approved type statics
- ✓ With European Technical Assessment (ETA)
- ✓ 6 different system profiles
- ✓ Up to 1.5 kN/m spar load
- ✓ Deployment also in sports facilities, tested ball impact safety
- ✓ LGA-tested safety
- ✓ Pane widths up to 6,000 mm, pane heights up to 2,100 mm
- ✓ Glass: VSG 2 x 6 mm, 2 x 8 mm and 2 x 10 mm with PVB or SGP 1.52 mm
- ✓ For private and public construction projects
- ✓ For indoors and outdoors

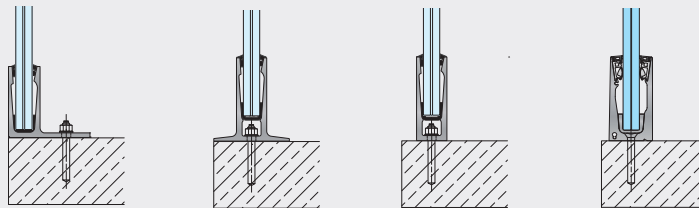

Anti-fall glazing DIN 18008

Floor mounting

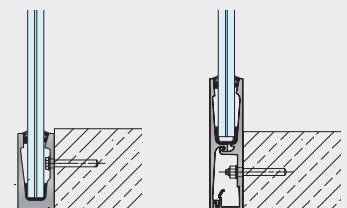

Side mounting

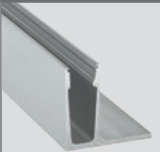
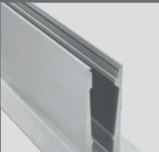
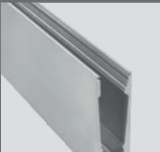
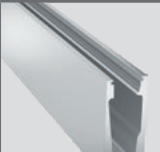

	Top 1	Top 2	Top 3	Top 4	Side 1	Side 3
Profiles						
Max. wind load with rail load of 0.5 kN/m & glass height of 1,100 mm	0.49 kN/m ²	1.81 kN/m ²	1.47 kN/m ²	2.02 kN/m ²	2.76 kN/m ²	1.93 kN/m ²
Max. wind load with rail load of 1.0 kN/m & glass height of 1,100 mm	0.49 kN/m ²	1.03 kN/m ²	0.47 kN/m ²	1.99 kN/m ²	2.20 kN/m ²	1.23 kN/m ²

The CLICK[®] N FIX mounting set

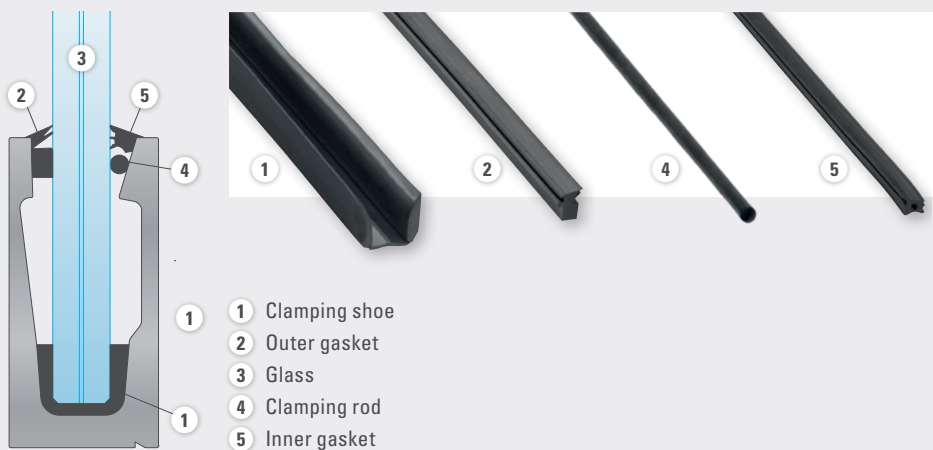

BALARDO *core smart*

The minimalist system for the private sector



- ✓ With General Building Inspectorate approval (AbP)
- ✓ With tested type statics
- ✓ Up to 1.0 kN/m spar load
- ✓ 3 different system profiles
- ✓ LGA-tested safety
- ✓ Quick and easy assembly
- ✓ Pane widths up to 6,000 mm, pulley heights up to 800 mm
- ✓ Glass: VSG 2 x 6 mm and 2 x 8 mm with PVB 0.76 mm or 1.52 mm
- ✓ For private and public construction projects
- ✓ Multidimensional tolerance compensation

Anti-fall glazing DIN 18008

Floor mounting

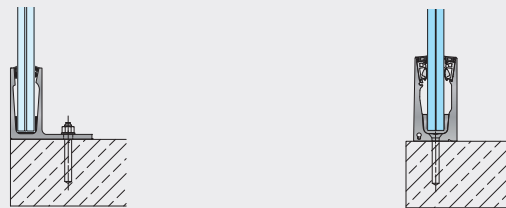

Side mounting

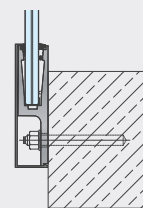

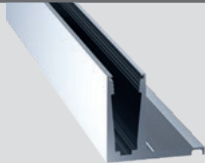
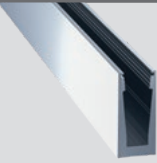
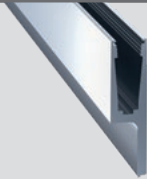
	Top 1	Top 4	Side 3
Profile			
Max. wind load with rail load of 0.5 kN/m & glass height of 800 mm, VGS 12	2.00 kN/m ²	2.00 kN/m ²	2.00 kN/m ²
Max. wind load with rail load of 1.0 kN/m & glass height of 800 mm, VGS 16	3.00 kN/m ²	3.00 kN/m ²	3.00 kN/m ²

The CLICK[®] N FIX mounting set



BALARDO *core hd*

The safe system for heavy loads

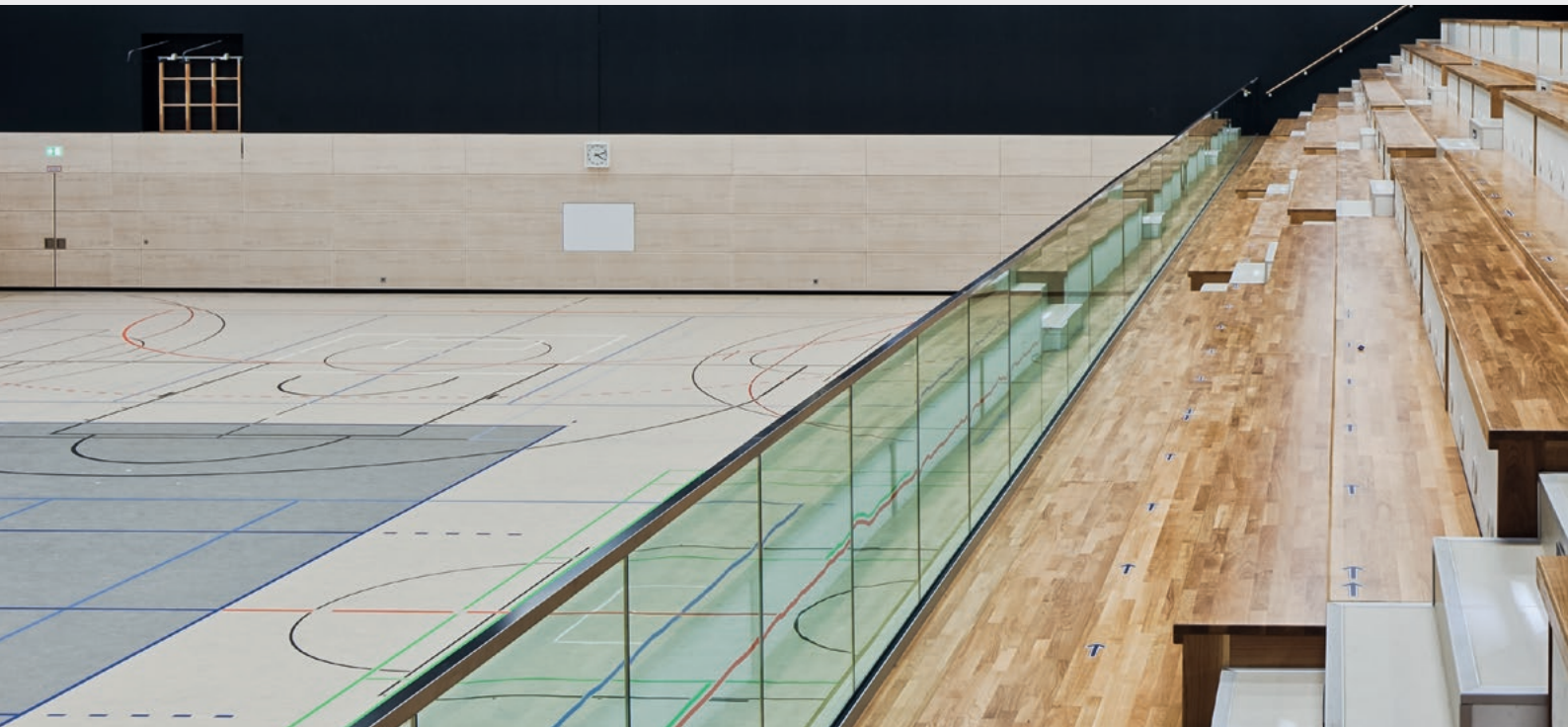

- ✓ With General Building Inspectorate approval (AbP)
- ✓ With approved type statics
- ✓ With European Technical Assessment (ETA)
- ✓ Rail loads up to 5 kN/m
- ✓ Deployment also in sports facilities, tested ball impact safety
- ✓ LGA-tested safety
- ✓ Pane widths up to 6,000 mm, pane heights up to 2,100 mm
- ✓ Glass: VSG 2 x 12 mm and 2 x 15 mm with PVB or SGP 1.52 mm
- ✓ For public construction projects
- ✓ For indoors and outdoors
- ✓ Areas for large gatherings of people
- ✓ For extreme wind loads

Anti-fall glazing DIN 18008

Floor mounting

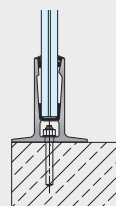
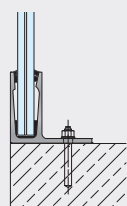

Side mounting

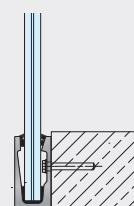

	Top 1	Top 2	Side 1
Profile			
Max. wind load with rail load of 2,0 kN/m & glass height of 1,100 mm	3.21 kN/m ²	3.21 kN/m ²	3.21 kN/m ²
Max. wind load with rail load of 5,0 kN/m & glass height of 1,100 mm	2.89 kN/m ² Max. glass height 700 mm	2.23 kN/m ²	2.97 kN/m ² Max. glass height 700 mm

The CLICK[®] N FIX mounting set



BALARDO steel

The system for the toughest requirements



- ✓ 1 support profile and 2 glass mounting systems: wedge system and rod system
- ✓ 13 Systems for connection from above and laterally to the Structural body for screwing or welding on
- ✓ Quick and easy assembly
- ✓ Up to 1.0 kN/m spar load
- ✓ Glass panes up to 6,000 mm width and 1,400 mm height
- ✓ Glass structures VSG 2 x 8 mm and 2 x 10 mm with PVB 1.52 mm
- ✓ For indoors and outdoors
- ✓ With European Technical Assessment (ETA)

Building connection

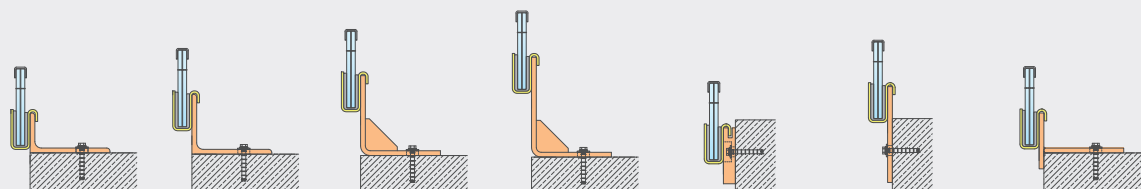

	System 1	System 2.A	System 2.B	System 2.C	System 3	System 4	System 5
Max. wind load with rail load of 0.5 kN/m & glass height of 1,100 mm	2.10 kN/m ²	2.10 kN/m ²	2.10 kN/m ²	2.10 kN/m ²	2.10 kN/m ²	2.10 kN/m ²	2.10 kN/m ²
Max. wind load with rail load of 1.0 kN/m & glass height of 1,100 mm	1.65 kN/m ²	1.65 kN/m ²	1.65 kN/m ²	1.65 kN/m ²	1.65 kN/m ²	1.65 kN/m ²	1.65 kN/m ²

Building connection

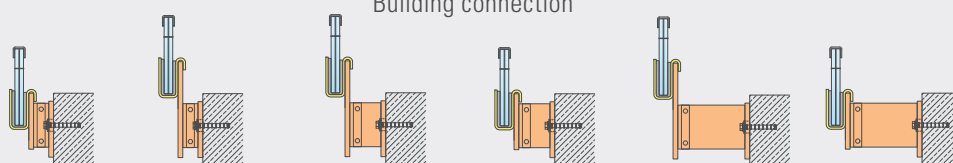

	System 6	System 7	System 8	System 9	System 10	System 11
Max. wind load with rail load of 0.5 kN/m & glass height of 1,100 mm	2.10 kN/m ²	2.10 kN/m ²	2.10 kN/m ²	2.10 kN/m ²	2.10 kN/m ²	2.10 kN/m ²
Max. wind load with rail load of 1.0 kN/m & glass height of 1,100 mm	1.65 kN/m ²	1.65 kN/m ²	1.65 kN/m ²	1.65 kN/m ²	1.65 kN/m ²	1.65 kN/m ²

The mounting set

Wedge system

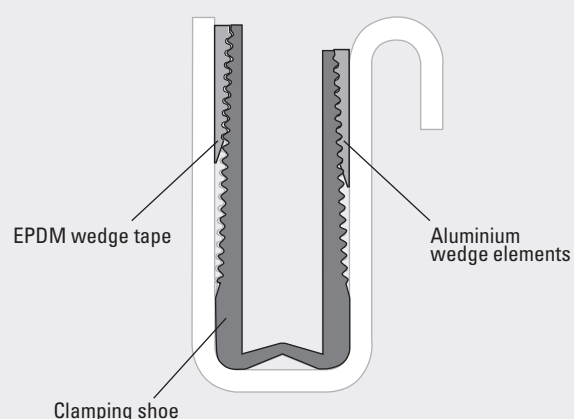

Rod system

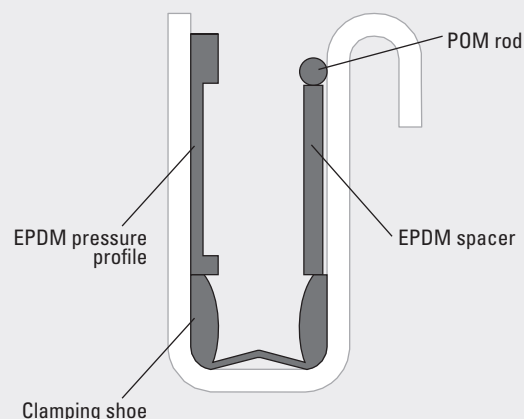

BALARDO *wave*

Curved all glass railing systems



- ✓ With General Building Inspectorate approval (AbP)
- ✓ LGA-tested safety
- ✓ No approval required for each individual case (ZIE)
- ✓ With fall-protection function
- ✓ Bending radii: aluminum ≥ 650 mm and steel ≥ 760 mm
- ✓ Cuts individually made to measure
- ✓ Surface ground and anodized or untreated
- ✓ Delivery of the profiles with the final surface appearance, including drillings

Anti-fall glazing DIN 18008

Floor mounting

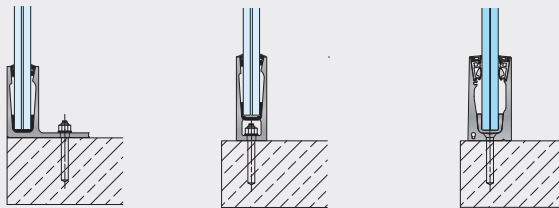

Side mounting

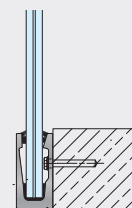

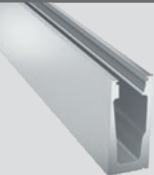
	Top 1	Top 3	Top 4	Side 1	support profile
Profiles					
System	core	core	core	core core hd	steel
Min. bending radius	1,000 mm	650 mm	650 mm	650 mm 1,000 mm	800 mm

BALUGA *easy*

Modular aluminium railing system for easy assembly

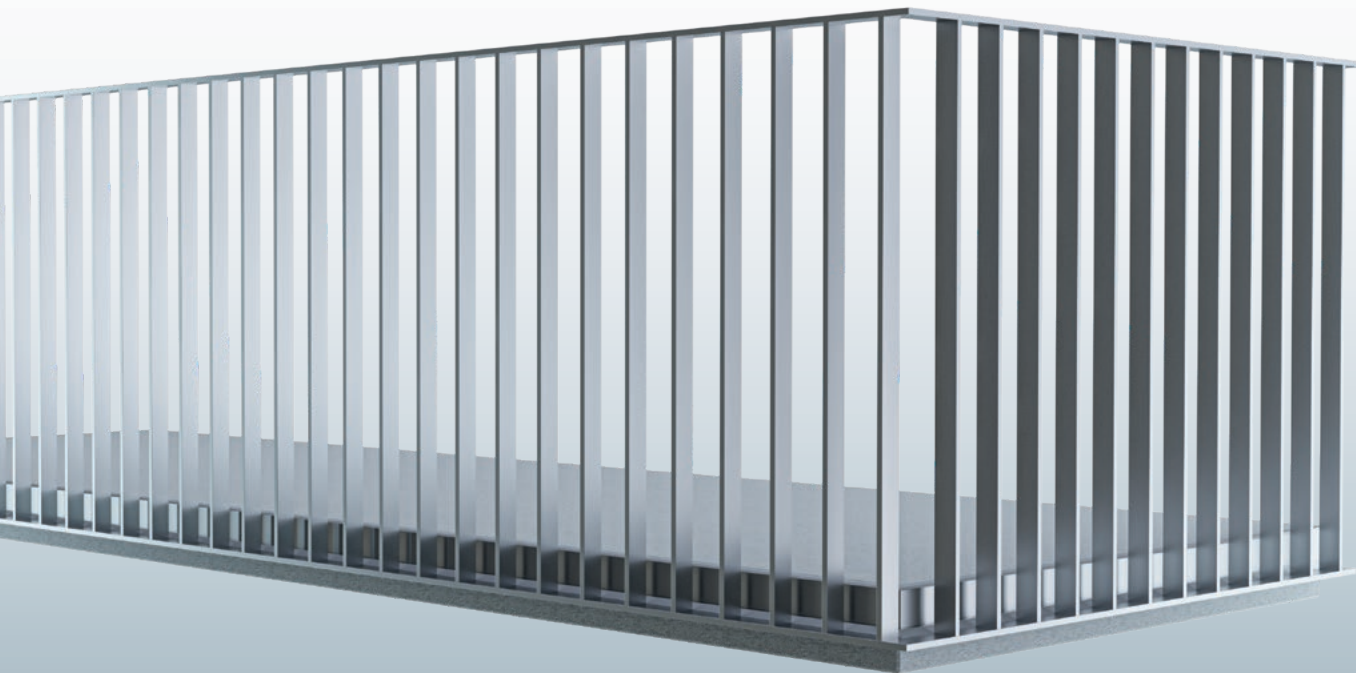

- ✓ Lightweight modules made of aluminium without welds
- ✓ "Online system configurator" - The fast way to your railing
- ✓ Large stock program - short delivery times
- ✓ LGA-tested safety with tested type statics
- ✓ Multidimensional tolerance compensation*
- ✓ Smooth high quality aluminium surface
- ✓ No visible screw connections*
- ✓ Concealed cable routing for e.g.screw on solar modules, connect - Done!
- ✓ Also available as a French balcony

*only for lateral mounting

Floor mounting

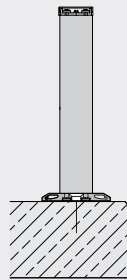

Side mounting

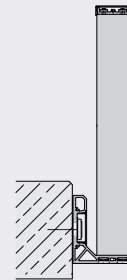

	Top 1	Side 1 top	Side 1 bottom
Dowel spacing with rail load of 0.5 kN/m	500 mm	250 mm	500 mm
Dowel spacing with rail load of 1.0 kN/m	250 mm		250 mm
Max. rod length with rail load of 0.5 kN/m	1,300 mm	1,200 mm	1,500 mm
Max. rod length 1300 mm with rail load of 1.0 kN/m	1,200 mm		1,200 mm

BALMERO

The French balcony



- ✓ Simplest possible attachment, approved for plastic, aluminium, wood and wood-aluminium windows
- ✓ Simply align the profile and secure with self-tapping or wood screws
- ✓ The system is structurally certified for
 - glass
 - support profile
 - fastening to plastic, aluminium, wood and wood-aluminium windows

Of course also for use with roller shutter rails

- ✓ No additional verifications, no special screws and no special tools required
- ✓ All required proofs according to building law included
- ✓ With General Building Inspectorate approval (AbP) for the glass and connection to window profiles

Profile dimensions

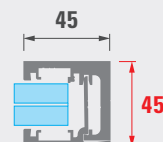
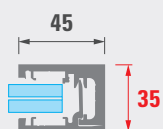

	BALMERO 35	BALMERO 45
Glass projection	—	✓
max. glass height	500 to 1,200 mm	400 to 1,200 mm
Glass thickness	2 x 5 and 2 x 6 mm	2 x 5, 2 x 6 and 2 x 8 mm
Roller blind rail	✓	✓
Centre posts	✓	✓
BALMERO firstglass	—	✓
Frontal Attachment (in the reveal)	—	✓

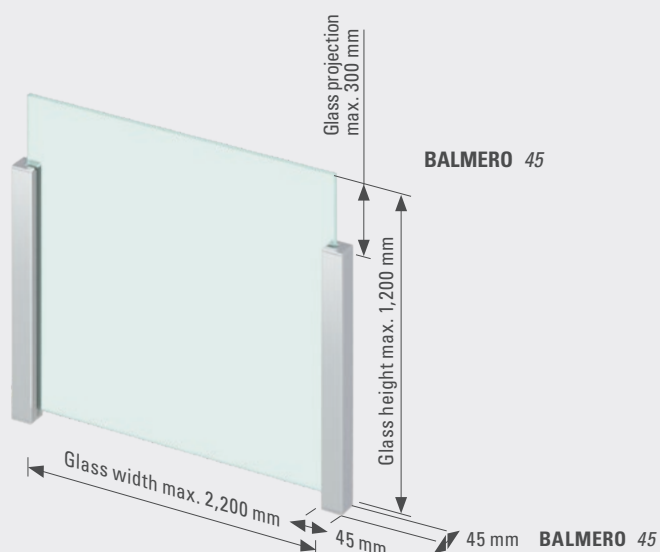
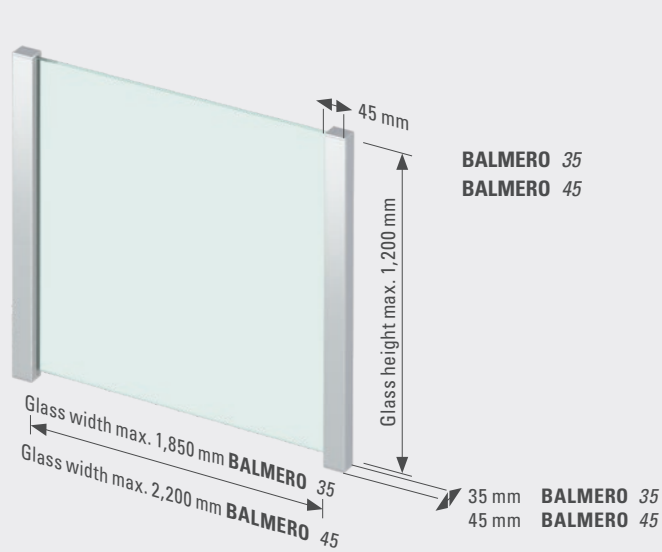

CANOPY *cloud*

Line bearing canopy system



- ✓ Projection up to 1,900 mm
- ✓ Glass width up to 3,000 mm
- ✓ Only linearly mounted on one side
- ✓ For snow loads up to 4.3 kN/m² (corresponds to approx. 4.3 m new snow height!)
- ✓ The simplest installation principle without drilling the glass
- ✓ LED illumination possible
- ✓ Large glass storage program
- ✓ Online configuration tool for fast requests and orders
- ✓ With European Technical Assessment (ETA)

Profile cross section

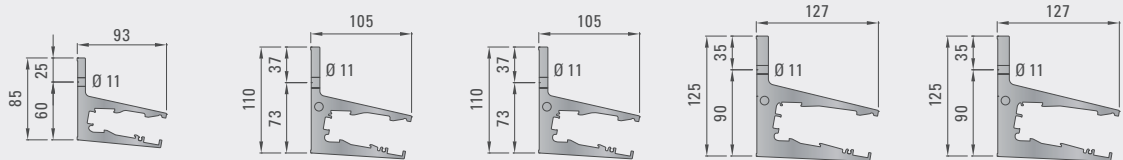

	System 1,100	System 1,300	System 1,500	System 1,700	System 1,900
Profiles					
Glass thickness	VSG 16	VSG 20	VSG 24	VSG 26	VSG 30
Max. projection at 1.6 kN/m² Load	1,100 mm	1,300 mm	1,500 mm	1,700 mm	1,900 mm
Max. load	3,1 kN/m ²	4,2 kN/m ²	4,2 kN/m ²	4,3 kN/m ²	4,3 kN/m ²
Max. projection at max. load	800 mm	900 mm	1,050 mm	1,150 mm	1,350 mm

The CANOPY *cloud* mounting set

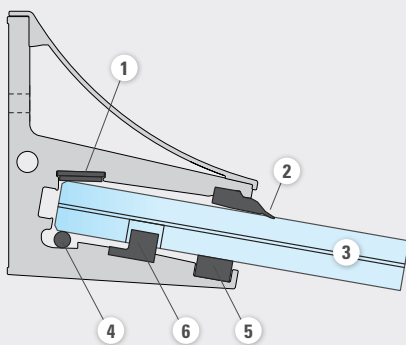

- 1 EPDM strip
- 2 Seal
- 3 Glass
- 4 Clamping rod
- 5 Support tape
- 6 Safety block

CANOPY *classic*

Point-to-point fixed canopy system



- ✓ With national technical approval (AbZ)
- ✓ With approved type statics
- ✓ Max. pane width up to 4500 mm
- ✓ High quality stainless steel suspension
- ✓ Large stock program - fast delivery times
- ✓ Various wall connection brackets
- ✓ High quality laminated safety glass
- ✓ With European Technical Assessment (ETA)

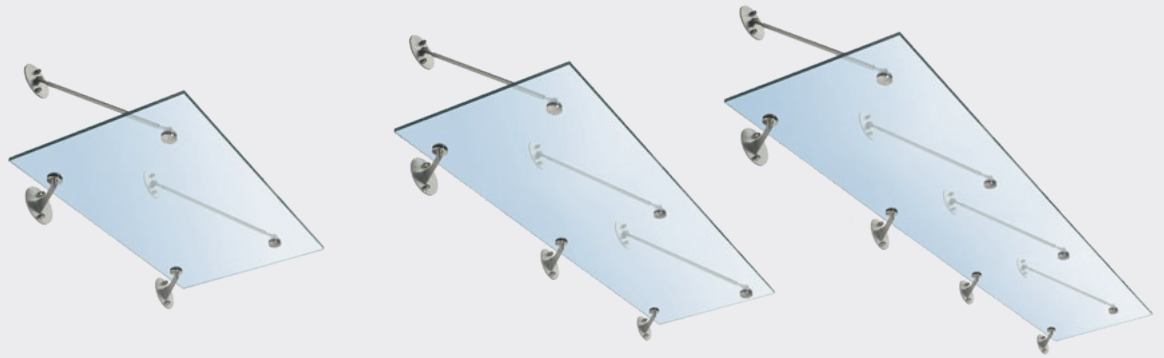

	System 1,100	System 1,300	System 1,500
Glass thickness	VSG 16 / VSG 20	VSG 16 / VSG 20	VSG 16 / VSG 20
max. dimensions	2,300 x 1,500 mm	3,200 x 1,680 mm	4,500 x 1,680 mm
Max. load	3.75 kN/m ²	2.05 kN/m ²	2.05 kN/m ²

POINTFIX



- ✓ With national technical approval (AbZ)
- ✓ With general type approval (ABG)
- ✓ With General Building Inspectorate approval (AbP)
- ✓ With European Technical Assessment (ETA)
- ✓ With type static calculations
- ✓ Point-supported glazing according to DIN 18008-3
- ✓ Additional requirements for fall-proof glazing according to DIN 18008-4
- ✓ Point holder with safety ball joint

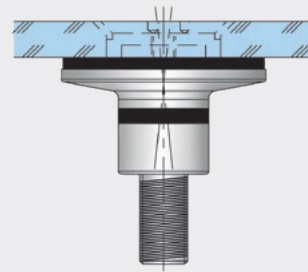
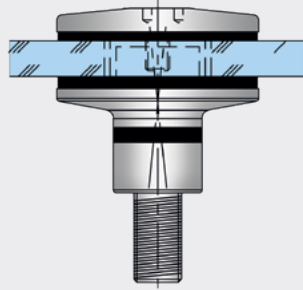

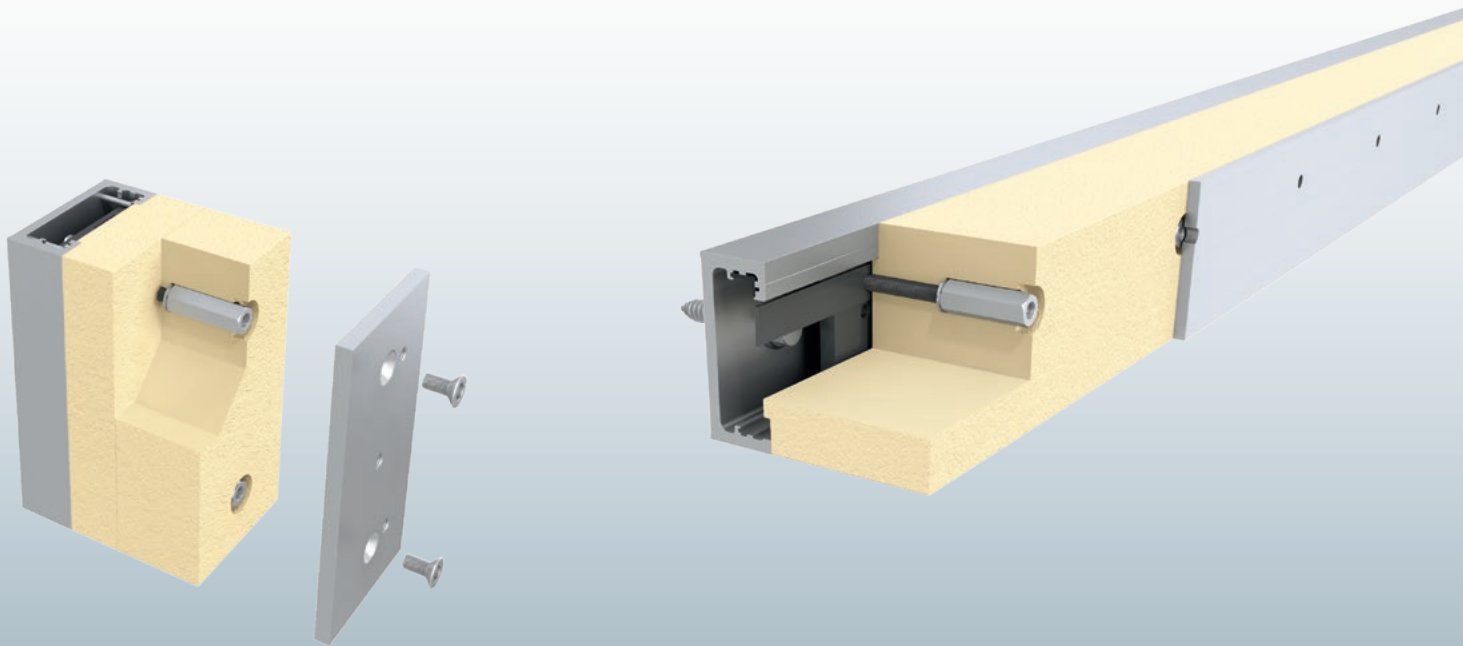

	Plate head	Countersunk head
Point supports		
without joint	PH 707 Ø68 mm PH 705 Ø52 mm PH 602 Ø35 mm	PH 799 Ø42/80 mm PH 790 Ø42/68 mm PH 792 Ø26/52 mm PH 789 Ø26/45 mm
with joint	PH 800 Ø80 mm PH 791 Ø68 mm PH 793 Ø52 mm PH 794 Ø49 mm	PH 703 Ø42/68 mm PH 701 Ø26/52 mm PH 613 Ø20/35 mm

FIX'N SLIDE

For safe attachment to building envelopes with ETICS

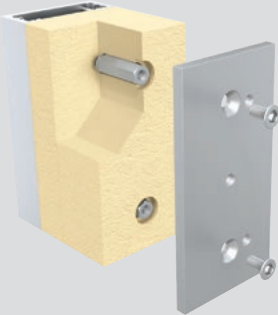
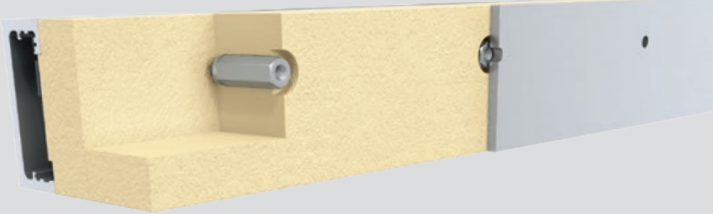
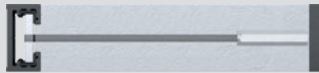
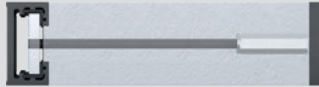
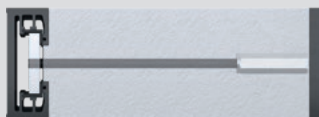
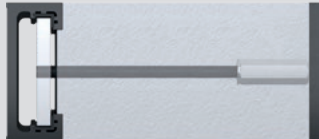
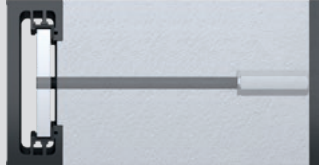

- ✓ Reduction of thermal bridges Secure fastening of add-on elements
- ✓ Thermal properties / energy planning according to EnEV 2016
- ✓ Safe load introduction
- ✓ Variable attachment methods
- ✓ Modular and flexible
- ✓ Application-independent bridging of the insulation system
- ✓ Safety in case of fire
- ✓ Flexible application – for new constructions or retrofitting

	Point-to-point	Linear																																																																						
Connection																																																																								
Possible insulation thicknesses	<div><div>48</div><div>48 mm</div><div>55 – 305 mm*</div></div> <div><div>60</div><div>60 mm</div><div>55 – 305 mm*</div></div> <div><div>80</div><div>80 mm</div><div>55 – 305 mm*</div></div> <div><div>100</div><div>100 mm</div><div>65 – 315 mm*</div></div> <div><div>120</div><div>120 mm</div><div>65 – 315 mm*</div></div>	<p>Available depths without optional connecting plate</p> <table><tr><td>50</td><td>70</td><td>80</td><td>100</td><td>120</td><td>140</td><td>160</td><td>180</td><td>200</td><td>220</td><td>240</td><td>260</td><td>280</td><td>300</td></tr></table> <table><tr><td>55</td><td>75</td><td>85</td><td>105</td><td>125</td><td>145</td><td>165</td><td>185</td><td>205</td><td>225</td><td>245</td><td>265</td><td>285</td><td>305</td></tr></table> <table><tr><td>55</td><td>75</td><td>85</td><td>105</td><td>125</td><td>145</td><td>165</td><td>185</td><td>205</td><td>225</td><td>245</td><td>265</td><td>285</td><td>305</td></tr></table> <table><tr><td>65</td><td>85</td><td>95</td><td>115</td><td>135</td><td>155</td><td>175</td><td>195</td><td>215</td><td>235</td><td>255</td><td>275</td><td>295</td><td>315</td></tr></table> <table><tr><td>65</td><td>85</td><td>95</td><td>115</td><td>135</td><td>155</td><td>175</td><td>195</td><td>215</td><td>235</td><td>255</td><td>275</td><td>295</td><td>315</td></tr></table>	50	70	80	100	120	140	160	180	200	220	240	260	280	300	55	75	85	105	125	145	165	185	205	225	245	265	285	305	55	75	85	105	125	145	165	185	205	225	245	265	285	305	65	85	95	115	135	155	175	195	215	235	255	275	295	315	65	85	95	115	135	155	175	195	215	235	255	275	295	315
50	70	80	100	120	140	160	180	200	220	240	260	280	300																																																											
55	75	85	105	125	145	165	185	205	225	245	265	285	305																																																											
55	75	85	105	125	145	165	185	205	225	245	265	285	305																																																											
65	85	95	115	135	155	175	195	215	235	255	275	295	315																																																											
65	85	95	115	135	155	175	195	215	235	255	275	295	315																																																											

Notes



GLASSLINE GmbH

Industriestraße 7-10
74740 Adelsheim, Germany
Phone: +49 (0) 6291 6259-0
Fax: +49 (0) 6291 6259-11
info@glassline.de
www.glassline.de

System solutions for sophisticated, frameless glass architecture and safe attachment of add-on pieces to thermal insulation systems.

As a leading supplier, GLASSLINE develops, manufactures and markets high-quality system solutions in the areas of point fixing systems, all-glass railing systems, frameless canopy constructions and systems with thermal break for the secure fixing of add-on elements to building envelopes.

Copyright 2023 by GLASSLINE GmbH - Edition March 2023 - Subject to technical changes
We assume no liability for printing errors and mistakes.

- All drawings are example applications. GLASSLINE assumes no warranty or liability for any transferable applications.
- We reserve the right to make technical and design changes.
- All screw connections are durable, e.g. secured against loosening, such as through gluing.
- Object-specific application as well as the verifications of load introduction and transfer must be checked and carried out by the customer.

